

## // Up-and-Over Garage Doors N80 and F80 in All Steel Infill Designs



# Up-and-Over Garage Doors

More Than Twenty Designs in Steel and Timber





# The Original Hörmann Up-and-Over Garage Door

**The Ultimate in Quality and Aesthetics**

Everything speaks in favour of the original: quality and safety, aesthetics and convenience, and of course engineering excellence. Every Hörmann up-and-over door produced is the result of more than 50 years' experience in the building of garage doors. That's why Hörmann is Europe's No. 1 manufacturer of up-and-over garage doors. And the wide variety of styles means you're sure to find the perfect door to complement your home.

# Contents



<b>Ribbed Steel Garage Doors</b>	<b>4</b>
<b>Steel Door Versions</b>	<b>6</b>
<b>Panelled Steel Garage Doors</b>	<b>8</b>
<b>Doors with Solid Timber Infill</b>	<b>10</b>
<b>Design-Line Doors with Solid Timber Infill</b>	<b>12</b>
<b>Open-for-infill Door</b>	<b>14</b>
<b>The Full Range of Steel Designs at a Glance</b>	<b>16</b>
<b>Glazing and Handles</b>	<b>22</b>
<b>Door Renovations</b>	<b>24</b>
<b>Renovating Ready-Built Garages</b>	<b>26</b>
<b>Automatic Doors with Electric Operator</b>	<b>28</b>
<b>Safety Features</b>	<b>30</b>
<b>Door Sizes, Fitting Dimensions</b>	<b>32</b>
<b>Overview of Side and Wicket Doors</b>	<b>38</b>

Some of the doors shown in this brochure have special features and therefore do not always represent the standard version.

Due to the limitations of the printing process, the colours and surface finishes shown cannot be regarded as binding.

Copyright. No part of this brochure may be reproduced without our permission. Subject to changes.

## Certified brand quality with long-term guarantee

It goes without saying that Hörmann doors and operators are precisely matched and for your safety are tested by the TÜV (German Technical Inspectorate) and for compliance with the relevant standards.

Manufactured according to the Quality Management System DIN ISO 9001, **they meet all the requirements of the European Standard 13241-1** (further details on pages 30-31).

\* Terms and conditions of the guarantee, specifications and all further details on Hörmann up-and-over doors can be found on our website at **www.hoermann.com**



Design 902 vertically ribbed steel



# The Classic Designs in Steel

Horizontally or vertically ribbed

Timeless in appearance and always up-to-date. A ribbed infill is a firm favourite every time. Whether the steel ribs are arranged horizontally or vertically, accentuated by a horizontal or vertical frieze. What's more you have the possibility of lending your door its own distinct character: by adding a beautiful handle, selecting the colour of your choice or including light-transmitting windows.



Design 957 in the new colour CH 703, matching many Hörmann entrance doors.



Design 941 ribbed steel with surface-mounted frieze, for double garages up to 5 m wide.



Design 902 in the factory colour Window Grey with integral wicket door, extremely practical when there is no space for a garage side door.



Design 968 ribbed steel in the factory colour Traffic White.



**Bring colour into play!**

Garage doors don't always have to be white. Information on the broad colour spectrum can be found on page 17.

**Long-term protection to resist weathering**

The galvanized material with high-grade powder-coating affords the best possible protection against corrosion. So you can be confident that your door will retain its good looks for many years to come.



Design 984 with vertically panelled infill in the factory colour Light Grey, similar to RAL 7035, matching the windows and entrance door.



## The Interesting Steel Versions

Panelled infill, chevron-style ribbing, door with ventilation slots

The wide panelled infill is especially complementary to properties featuring contemporary architecture and clean distinct lines. The chevron design infill is the ideal choice for garages with a matching gable roof and for homes in the country house style. The steel door with ventilation slots is particularly recommended for underground and collective garages.



Design 985 steel panels with Decograin® surface finish "Rosewood", as a double garage door to complement classic architecture.



Design 990 ribbed steel, chevron style. Colour co-ordinated to reflect the country house style.



Design 984 panelled steel. In colour harmony with the entrance door.



Design 914 ribbed steel with ventilation slots. As required by the relevant regulations for underground and collective garages.



The broad spectrum of special colours can be found on page 17.



A beautiful handle always provides a special highlight.

Design 972 with matching side door in crisp-looking Traffic White (standard colour).



## Attractive Steel Panels

Highly popular and fully in keeping with current trends

With Hörmann there are five different panel designs to choose from. One of them is sure to complement the architectural style of your home. We now offer all the designs in the new Decograin® surface finishes “Golden Oak” and “Rosewood”. To improve the lighting conditions in your garage, most of the panel designs can also be supplied with glazing elements.





Design 976 with "cathedral-style" top panel to echo the style of the entrance door.



Design 970 in the factory colour Dove Blue with glazing to take full advantage of daylight.



Design 974. An interesting look featuring panels of differing sizes.



Design 976 in the new Decograin® surface finish "Golden Oak".



Coloured doors catch the eye. The full range of colours is shown on page 17.

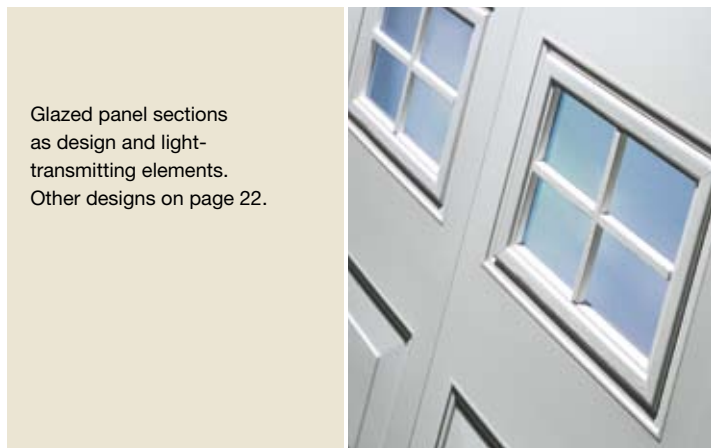

Glazed panel sections as design and light-transmitting elements. Other designs on page 22.

Design 934 Nordic Pine as a double garage door with site-fitted fascia panel, in the style of the gable cladding.



# The Beauty of Nature

Solid timber infills in exquisite quality

If timber determines the appearance of your home, then opting for a garage door in solid timber is the logical choice. Hörmann offers you a range of twelve different designs: vertically or horizontally boarded, in a chevron or rhombus style. For our Softline timber boarding we use carefully selected, superior quality timber profiles of Nordic Pine and Hemlock which we have pretreated using a colourless wood preservative - the best protection against insect and fungal attack.



Design 936 basic Nordic Pine, the favourably-priced vertically boarded up-and-over door.



Design 927 Nordic Pine with triangular glazing, integrated into the rhombus design.



Design 931 Nordic Pine in chevron style, with individual wood stain coating.



Design 934 Nordic Pine, vertical boarding, matching the entrance door.

### Wood needs protecting

That's why in addition to the impregnation provided at the factory, it is important for you to apply a pigmented wood preservative to your timber garage door to protect it against atmospheric influences and the effects of UV rays.

In the process you can paint the naturally light-coloured softwood according to your own colour scheme to blend in with the timber elements of your property.

You will find instructions on the site treatment and painting of timber in our fitting manual.

**An overview of all 7 timber designs is provided on pages 18 and 19.**



When you subsequently treat your timber door - an essential measure to protect it from UV rays - you can also use another wood preservative, such as teak finish.



# The Exclusive Design-Line Timber Doors

Also in the partner look with entrance doors

With Hörmann's Design Line you stamp your own personal mark on your house and garage, thereby setting your property apart from the rest. Thanks to the many design variants with stylishly arranged elements, these Design-Line doors are guaranteed to catch the eye, particularly when combined with Hörmann Design-Line entrance doors.

## Garage Door and Aluminium Entrance Door with Stylish Stainless Steel Embellishments

If up until now the entrance door was your home's sole "visiting card", you can now afford your garage door the very same status. Be inspired by the beautiful designs and the myriad of options available to you.

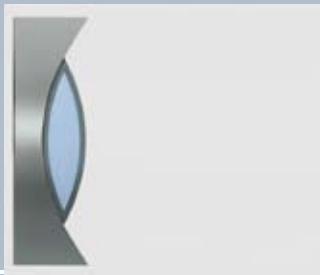

Garage door design 41



Entrance door design 41A



Garage door design 45



Entrance door design 45A



Garage door design 62



Entrance door design 62A



Garage door design 689

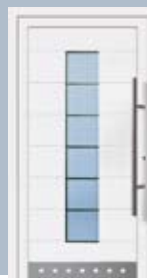

Entrance door design 689 A

The door leaves comprise a highly rigid multi-layer timber infill which is finished with a triple silky matt coating in Pure White. With Hörmann the frame surround is already primed with a white polyester powder-coating.

There is a slight difference in colour and degree of lustre between the garage doors and the entrance doors on account of the different materials used.



**Design-Line doors are automatic doors**  
Design and convenience are the hallmarks of these exclusive garage doors. That's why we supply them without a handle. The standard equipment does not include the necessary operator. We recommend Hörmann's new SupraMatic operator.

Design 905 prepared for an on-site infill,  
for a door with a unique appearance.

## This is the solid basis

- **Extremely sturdy frame construction with reinforced struts Fully welded!**
- **Fully galvanized, door leaf frame additionally with high-grade polyester primer coating. (similar to RAL 8028).**
- **Frame and struts predrilled at 30 mm spacings.**
- **Illustrated fitting instructions with suggested designs**

### Infill weight

Depending on the door size, between 6 and 10 kg/m<sup>2</sup>  
Doors for double garages up to a maximum of 16 kg/m<sup>2</sup>  
See also page 33.



It's fun to be hands on  
and watch your own  
ideas take shape.



# Design Your Own Door

We provide the solid basis

Applying the timber boarding couldn't be easier. Because Hörmann supplies the frame and struts predrilled at 30 mm spacings. Give free rein to your creative talent: regardless of whether the timber boarding is arranged vertically, horizontally or according to your own design. You can proudly show off your own creation.

You have full creative freedom.



This door construction offers you two design options:

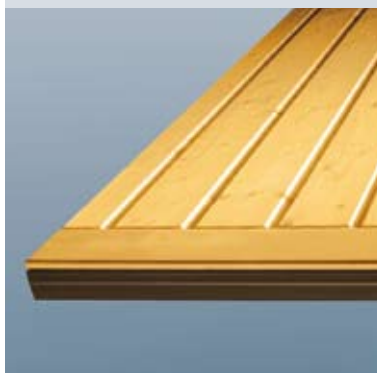

Infill overlapping the frame, whereby the frame and bottom section are entirely concealed.

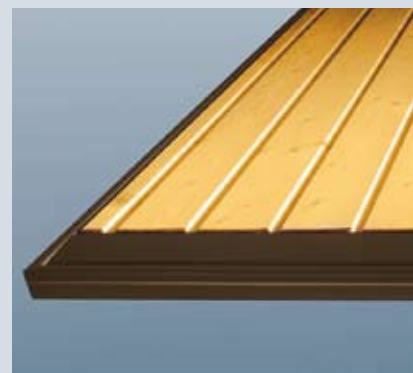

Timber infill within the frame with visible bottom section to protect against spray water.

**Advice on site treatment**

Once fitted, it is essential that you treat your door with a commercially available pigmented wood preservative to protect it against UV rays as well as fungal and insect attack.

# The Full Range of Steel Designs at a Glance



● 902 Vertically ribbed steel

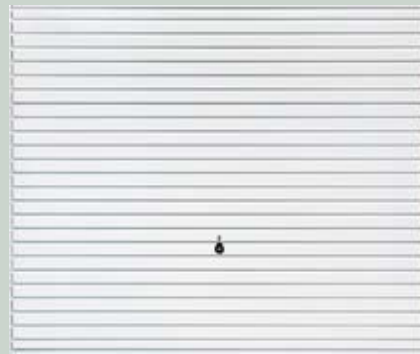

● 968 Horizontally ribbed steel



● 941 Ribbed steel with surface-mounted frieze



● 957 Ribbed steel with central profile / side profiles

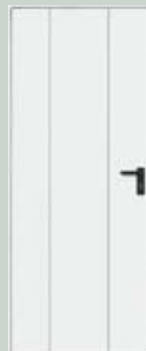

● 984 Vertically panelled steel



● 985 Horizontally panelled steel



● 990 Ribbed steel, chevron style

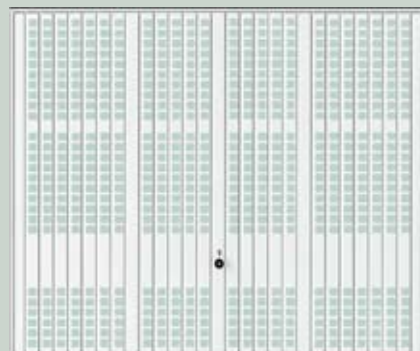

● 914 Ribbed steel with ventilation slots

**Maximum door widths**

- Up to 2500 mm
- Up to 2750 mm
- Up to 3000 mm
- Up to 3250 mm

Design 902 available as door type DF98 for double garages of up to 5000 mm width.

Designs 902 and 905 are also available with an integral, outwards opening wicket door.

All side doors can also be obtained as double-leaf versions.





● 970 Panelled steel



● 972 Panelled steel



● 974 Panelled steel



● 976 Panelled steel

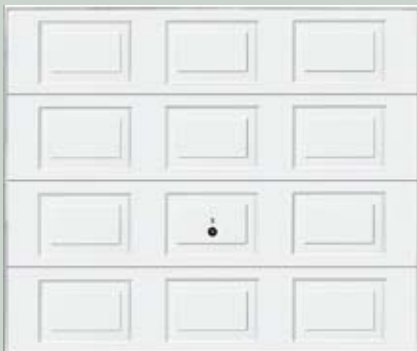

● 978 Panelled steel

**High-grade powder-coating in a polyester primer**

The galvanized door leaves are protected against corrosion and the adverse effects of the environment right into the cut edges. Garage doors and side doors are available as standard in competitively-priced Traffic White and in 15 equally-priced preferred colours as well as around 200 colours from the RAL colour chart.



Matching the Hörmann entrance door styles, we can now supply Hörmann up-and-over doors in an exceptionally elegant-looking textured lacquer finish in CH 703 anthracite.

**15 factory colours, one price. Or in the good-value standard colours Traffic White.**

Traffic white RAL 9016	White aluminium RAL 9006	Terra brown RAL 8028	Clay brown RAL 8003	Ochre brown RAL 8001	Window grey RAL 7040	Light grey RAL 7035	Stone grey RAL 7030
Anthracite grey RAL 7016	Fir green RAL 6009	Moss green RAL 6005	Dove blue RAL 5014	Steel blue RAL 5011	Sapphire blue RAL 5003	Ruby red RAL 3003	Light ivory RAL 1015

The colours shown are subject to the limitations of the printing process and cannot be regarded as binding. In the case of coloured garage doors, please seek the expert advice of your Hörmann specialist dealer. All colours are based on RAL. Outside and inside generally in the same colour.

# The Full Range of Solid Timber Designs



933 Horizontal timber boarding



934 Vertical timber boarding ●



925 Diagonal timber boarding



931 Timber boarding, chevron style



937 Timber boarding with horizontal central profiles



927 Timber boarding, rhombus style

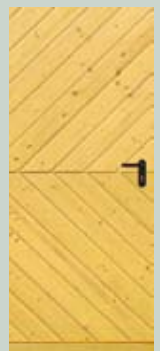

**All the designs are available in two wood types**



Nordic Pine



Hemlock

All the styles (except style 936 basic) are supplied as standard with exclusive surface-mounted wood cladding on the door leaf and frame. On request, the frame can also be supplied without wood cladding.

**Softline-Design because it looks so much better!**

That's why all the timber boards (120 x 14 mm) rounded. And that lends the timber designs their appealing aesthetics (not for design 936 basic).





936 basic vertical timber boarding in Nordic Pine // NEW



**The basic 936 style**

is not available with the exclusive wood cladding. The garage door cladding is made from rounded, planed timber profiles in the wood type Nordic Pine, reverse face impregnated with a primer and in some places still with the roughness of sawn timber.

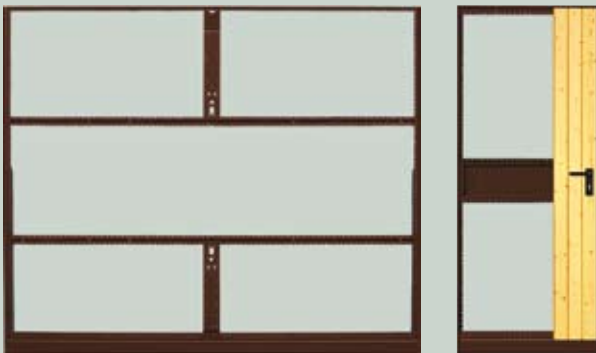

905 Open-for-infill ●

also double-leaf

All designs as the N80 door type up to 3000 mm wide.

- We also supply these designs as the DF 98 door type for double garages up to 5000 mm wide.

All timber infill doors are supplied foil-wrapped to protect them during transit and site storage.

**6 colours for timber doors**

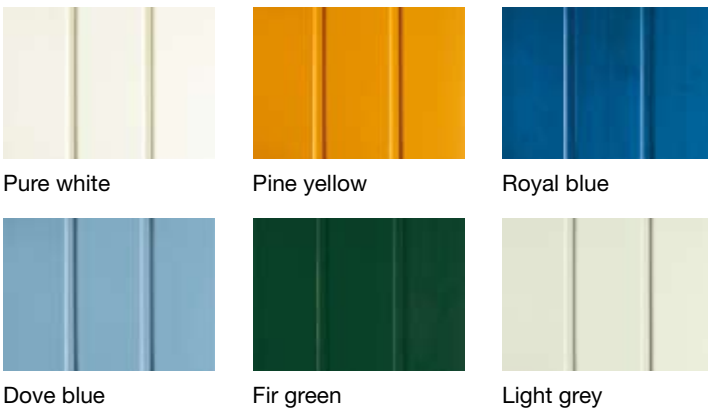

Pure white

Pine yellow

Royal blue

Dove blue

Fir green

Light grey

Besides producing a silky-matt sheen, three coats of paint make the surface light-fast and weather-resistant. (Not for design 936 basic). So you can be confident that the doors will retain their good looks for many years to come. The door frame is powder-coated with a polyester primer: White for white and coloured garage doors, Terra Brown for stained timber doors.

**Door sizes**

Width up to 3000 mm  
Height up to 2500 mm

The colours shown are subject to the limitations of the printing process and cannot be regarded as binding. In the case of coloured garage doors, please seek the expert advice of your Hörmann specialist dealer. Outside and inside generally in the same colour. Wood preservatives and transparent coatings are also possible.

# The Full Range of Decograin<sup>®</sup> Steel Doors



970 Panelled steel



972 Panelled steel



974 Panelled steel



976 Panelled steel



984 Vertically Panelled



985 Horizontally Panelled

## The Decograin<sup>®</sup> surface finishes with the authentic appearance of real timber.

Decograin<sup>®</sup> "Golden Oak"Decograin<sup>®</sup> "Rosewood"

All the door designs shown are available in the Decograin<sup>®</sup> surface finishes "Golden Oak" and "Rosewood". This new UV-resistant plastic sheeting on the outside of the door leaf combines the benefits of a sheet steel door with the true-to-original look of wood as a natural material. Thanks to the special surface protection, the door retains its good looks for much longer.

# The Full Range of Design-Line Timber Doors

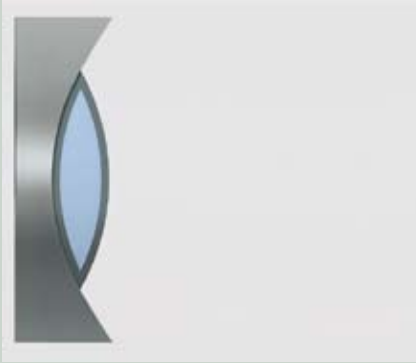

## Design 41

Smooth timber infill  
Single-pane safety glass  
Parsol Grey, sand-blasted  
Large arch-style embellishment  
in brushed stainless steel,  
with clear edge.



## Design 45

Smooth timber infill  
Single-pane safety glass  
Parsol Grey, sand-blasted  
with distinct horizontal stripes  
Glazing frame and flush-fitting  
brushed stainless steel  
bottom strip.



## Design 62

Smooth timber infill  
Single pane safety glass  
Mastercarré White  
with glazing frame and  
flush-fitting, brushed stainless  
steel bottom strip.

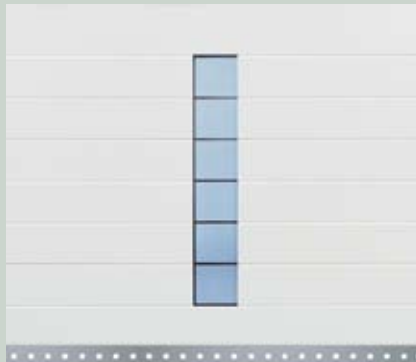

## Design 689

Smooth timber infill  
with horizontal grooves,  
single pane safety glass  
Parsol Grey sand-blasted,  
with distinct horizontal stripes  
and flush-fitting brushed  
stainless steel bottom strip.

For these 4 Design-Line garage doors we have selected highly stable multilayer timber infills. Finished with a triple coating of pure white silky-matt paint, the surface is light-fast and weather-resistant. The door frame is powder-coated with a polyester primer.

### Door sizes

Width up to 3000 mm  
Height up to 2250 mm



### Detail of design 45

Thanks to the four possible design variants with stylishly arranged elements in stainless steel and glass, Hörmann Design-Line doors become an eye-catching feature and the expression of your good taste.



Figure 4: 283 x 203 mm



Figure 5: 283 x 203 mm



Figure 6: 283 x 203 mm

**Glazing in steel infills**

Available for the designs: 902, 941, 957, 970 und 972 (except Decograin®).  
Weather-resistant synthetic material.  
Colour: in a shade matching the colour off the garage door leaf.  
Glazing: 3 mm synthetic panes, clear or crystal structure.



Figure 21: 375 x 375 mm

**Glazing in timber infills**

Figure 21 for the designs: 925, 927 and 931. Figures 23 and 24 for the designs: 933, 934, 936 and 937.  
Material: timber, glazing: 3 mm. synthetic panes, clear or crystal structure.



Figure 23: 277 x 199 mm



Figure 24: 199 x 277 mm

# Let Your Garage See the Light of Day !

Glazing is more than just a design feature, it also saves you having to build an additional window in your garage. Taking advantage of daylight means you can also use your garage as a workshop.

Side doors are available with a round handle set in all the materials shown. As standard with lever handles on both sides or on request with lever/knob handle set.



Black plastic as standard



Cast aluminium, white (similar to RAL 9016)



Cast aluminium, new silver finish



Cast aluminium, brass finish



Polished stainless steel



Brushed stainless steel



Cast aluminium, rustic style



Cast aluminium, bronze finish

The flush-fitting cylinder lock can also be mastered with other locks in your home.



## Beautiful Handles Add Value to Your Door

The garage door handle developed by designers and security experts is unique in its shape. Thanks to the ergonomic styling you always have a secure, comfortable grip.



## Out with the Old - in with the New

Quick and clean and all on the same day

»We're delighted that everything has gone so well. The new garage door blends in much better with the style of the house and the old garage door was disposed of at the same time. Our only regret is that we didn't invest in an electric operator years ago!«





**Fascia panels and renovation panels**

In the case of renovations, the structural opening can sometimes be higher and wider than the lower-priced standard-sized garage door. Hörmann solves this problem by offering aesthetically-pleasing top and side fascia panels to close the gaps. If masonry is damaged on removing the old garage door, a renovation panel provides a neat solution without the need for any further plastering.



**Extras for improved acoustic and thermal insulation**

Order your door with a special Dämmtec coating to provide good acoustic insulation right from the start. To improve the thermal insulation value, we can supply thermal insulation boards which you simply clip onto the inside of the garage door or you can have them prefitted at the factory.



**Three-point security latching**

As a DIY retrofit kit for all non power-driven up-and-over doors. It provides greater security to prevent your garage door from being forced open.



**Bottom rubber strip for an unbroken flat floor line**

With the flexible rubber strip in place, this will help keep out passing debris.



**Stainless steel weather bar**

Where garages face the elements, we recommend using a stainless steel threshold rail to ensure the bottom of the garage door remains free from rust for decades to come.



# Hörmann N80 and F80 Up-and-Over Doors

**Ideal for renovating ready-built garages and blocks of garages**

There will come a time when you just can't face painting the old garage door any more, not to mention the daily inconvenience of having to open a hinged-leaf door. It's then worthwhile investing in a new Hörmann up-and-over door in one of the many competitively priced standard sizes. It comes powder-coated with a weather-resistant polyester primer, looks good and is much easier to open too.

**// NEW** Now available in all steel designs,  
and a wide variety of colours and surfaces.

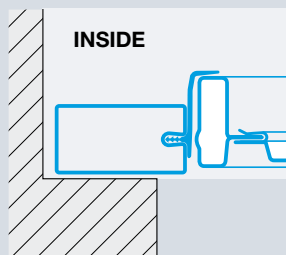

Door type N80  
Fitting behind the structural  
opening

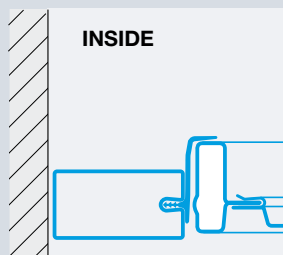

Door type N80  
Fitting in the structural  
opening

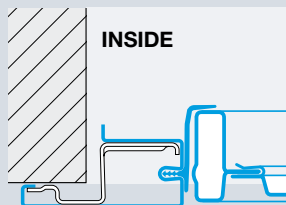

Door type F80  
Fitting in front of the  
structural opening

Depending on the installation  
situation or the space available,  
these three fitting methods are  
possible for renovations.

#### Renovate ready-built garages using competitively-priced standard sizes

- Quick and clean replacement of the garage door within the day
- 3 fitting methods to cover every installation situation
- Old doors are disposed of at the same time

Our recommendation for greater security:  
the retrofit kit for 3-point locking (see page 25).

Door sizes and fitting dimensions  
on pages 32, 34 and 37.

#### Best with an operator right from the start

Opening your garage door  
then becomes much more  
convenient and the automatic door  
latching makes it more secure against  
being forced open.

#### ProMatic Akku

The solution for prefabricated  
garages and garage yards without  
an electricity supply.

#### The solar module

You should also enquire about the  
ProMatic Akku solar module. This  
then saves you having to charge the  
accumulator manually.



The track-guided automatic up-and-over garage doors just keep running and running ...



## Hörmann Automatic Up-and-Over Doors

because they offer greater convenience and security

You can operate a Hörmann automatic door as conveniently as your TV set. On the press of a button, you drive into your garage, protected from all weathers. When it's dark, the direct route affords you greater safety and security. It goes without saying that Hörmann doors and operators are tested by the TÜV (German Technical Inspectorate) as a single safety unit.

## Choose between two innovative Hörmann operators

### ProMatic



The inexpensive starter model as an introduction to the Hörmann premium quality

#### ProMatic

For doors up to 5000 mm wide.  
Peak force: 650 N

#### ProMatic P

For doors up to 5500 mm wide.  
Peak force: 750 N

#### ProMatic Akku

For garages not connected to the mains supply and doors up to 3000 mm wide.  
Peak force: 400 N

### SupraMatic



The high-quality operator with an array of additional functions

- Halogen lighting can be switched on/off separately
- Door with additional opening height for a well ventilated garage

#### SupraMatic E

For doors up to 5500 mm wide.  
Peak force: 800 N

#### SupraMatic P

For doors up to 5500 mm wide, heavy timber doors and garage doors with wicket doors.  
Peak force: 1000 N

### The Operator Technology

- 868.3 MHz radio frequency with a stable range
- 4-button mini hand transmitter with secure code from more than 1 billion options
- Integral receiver
- Automatic door latching affords effective protection against forced opening.
- On encountering an obstruction, a reliable automatic cut-out stops the door immediately
- "A soft" start and "soft" stop saves wear and tear on both the door and operator
- Maintenance-free patented toothed belt.
- Internal emergency release
- Easy to install. Everything is precisely prepared.

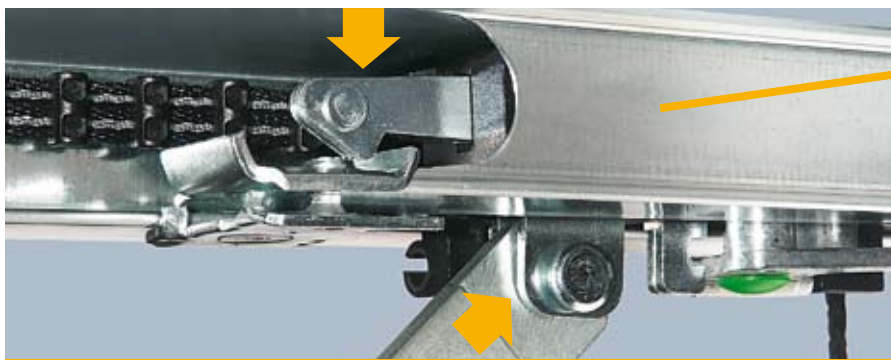

Door latching in the operator boom – a Hörmann patent



## ...with Automatic Door Latching

The operator system latches the door

The door automatically latches on closing, making it impossible to lever it open. This unique automatic latching system is a mechanical device, so remains fully functional even in the event of a power failure.



## Safety Features to the European Standard 13241-1

### Assured quality

Hörmann up-and-over doors are tested and certified singly and also in every combination with Hörmann operators according to the high safety requirements and performance characteristics of the European Standard 13241-1.

This gives you the reassurance that your purchase of a Hörmann up-and-over door is a safe investment.

**It's worthwhile making a comparison!**



### The door cannot crash to the floor! Of that you can be sure!

- 1 Multiple spring safety system**  
In the event that one of the springs should break, the others safeguard the door. A broken spring cannot fly off into the air.
- 2 Precision track guidance**  
prevents the door leaf from "derailing".
- 3 Unique track well**  
Once fully opened, the door is gently cushioned and always brought to a safe, reliable halt in the track well.
- 4 Protective caps over the lifting arms**  
Flexible plastic caps protect the entire joint area, so there's no risk of trapped fingers.
- 5 Protective profiles on door leaf and frame**  
Flexible plastic profiles down the sides act as reliable side trap guards between the door leaf and frame. Double garages have a flexible seal at the bottom to provide foot trap protection.
- 6 Safety distance between springs**  
The distance between the spring windings is so small that even children's fingers are reliably protected.

### No trapped fingers!

**Comprehensive finger-trap protection.**



### Extremely sturdy door construction

The wide galvanized block frame and the horizontal door leaf reinforcements lend the Hörmann up-and-over door a high degree of stability.

### A smooth, quiet door action

Everything is perfectly matched: the 4-point suspension, the precision track guidance, the smooth-running plastic rollers, the plastic profiles down the sides (no steel on steel contact) and the adjustable spring assemblies.

### Lock with two-fold benefit

If the house is entered directly from the garage, the garage door can also be locked from the inside using a security pin. The lock can be integrated into the building's master locking system.

### Well protected from all weathers

As standard via the bottom threshold rail and where there is an unbroken flat floor line, on request with a flexible rubber strip on the bottom profile (see page 25).

# Maximum Personal Safety

It's reassuring to know that the door comes with extensive safeguards

Hörmann up-and-over doors incorporate reliable safeguards to eliminate trap zones and prevent the door leaf from crashing to the floor. There could hardly be a more safer up-and-over door. And in terms of security, the latching systems ensure that you are always on the safe side. Irrespective of whether you opt for an automatic door or a manually operated door.

Complete with fixings and infinitely adjustable universal anchors, installation couldn't be easier.

On non-automated garage doors, the door comes to a safe halt in the track well.

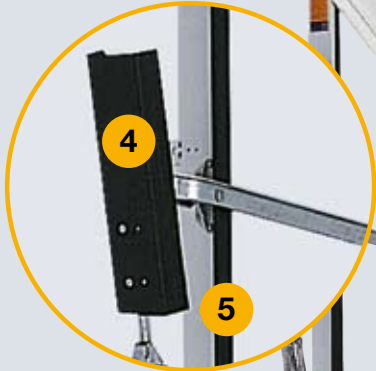

**Flexible plastic profiles and caps prevent trapped fingers.**



**Break-in-resistant due to unique rotary catch lock**

The door leaf corners are permanently attached to the frame in this type of locking system, which makes lifting the leaf out impossible.

**Patent pending**

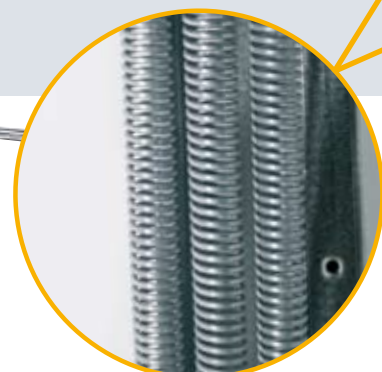

**Multiple spring safety system**

With optimally dimensioned adjustable spring assemblies depending on the door size and door weight:  
N80 door type: 3-4 springs per side,  
DF98 door type: 6-10 springs per side.

An easy-to-install retrofit kit allows you to equip your garage door with top latching in addition (see page 25).

# Up-and-Over Doors

## Door types N80 and DF 98

### Sizes and fitting dimensions

#### N80 standard sizes for single garages (depending on door design)

#### Dimensions in mm

Ordering size		Overall frame size		Clear passage dimensions*		Fitting behind the opening		Fitting in the opening	
						Recommended structural dimension (fitting area)	Recommended structural ** dimension (fitting area)	Structural dim.	
Width	Height	Width	Height	Width	Height	Width	Height	Width	Height
2250	1920	2355	1990	2110	1800	2250 (2215-2340)	1920 (1890-1950)	2375	1970
2250	2000	2355	2070	2110	1880	2250 (2215-2340)	2000 (1970-2030)	2375	2050
2250	2075	2355	2145	2110	1955	2250 (2215-2340)	2075 (2045-2150)	2375	2125
2250	2125	2355	2195	2110	2005	2250 (2215-2340)	2125 (2095-2155)	2375	2175
2375	1920	2480	1990	2235	1800	2375 (2340-2465)	1920 (1890-1950)	2500	1970
2375	2000	2480	2070	2235	1880	2375 (2340-2465)	2000 (1970-2030)	2500	2050
2375	2075	2480	2145	2235	1955	2375 (2340-2465)	2075 (2045-2105)	2500	2125
2375	2125	2480	2195	2235	2005	2375 (2340-2465)	2125 (2095-2155)	2500	2175
2375	2250	2480	2320	2235	2130	2375 (2340-2465)	2250 (2220-2280)	2500	2300
2375	2375	2480	2445	2235	2255	2375 (2340-2465)	2375 (2345-2405)	2500	2425
2500	1920	2605	1990	2360	1800	2500 (2465-2590)	1920 (1890-1950)	2625	1970
2500	2000	2605	2070	2360	1880	2500 (2465-2590)	2000 (1970-2030)	2625	2050
2500	2075	2605	2145	2360	1955	2500 (2465-2590)	2075 (2045-2105)	2625	2125
2500	2125	2605	2195	2360	2005	2500 (2465-2590)	2125 (2095-2155)	2625	2175
2500	2250	2605	2320	2360	2130	2500 (2465-2590)	2250 (2220-2280)	2625	2300
2500	2375	2605	2445	2360	2255	2500 (2465-2590)	2375 (2345-2405)	2625	2425
2500	2500	2605	2570	2360	2380	2500 (2465-2590)	2500 (2470-2530)	2625	2550
2500	2750	2605	2820	2360	2630	2500 (2465-2590)	2750 (2720-2780)	2625	2800
2625	2125	2730	2195	2485	2005	2625 (2590-2715)	2125 (2095-2155)	2750	2175
2750	2000	2855	2070	2610	1880	2750 (2715-2840)	2000 (1970-2030)	2875	2050
2750	2125	2855	2195	2610	2005	2750 (2715-2840)	2125 (2095-2155)	2875	2175
3000	2000	3105	2070	2860	1880	3000 (2965-3090)	2000 (1970-2030)	3125	2050
3000	2125	3105	2195	2860	2005	3000 (2965-3090)	2125 (2095-2155)	3125	2175

#### DF 98 standard sizes for double garages (depending on door design)

#### Dimensions in mm

Ordering size		Overall frame size		Clear passage dimensions*		Fitting behind the opening		Fitting in the opening	
						Recommended structural dimension (fitting area)	Recommended structural ** dimension (fitting area)	Structural dim.	
Width	Height	Width	Height	Width	Height	Width	Height	Width	Height
4000	2000	4096	2073	3840	1820	4000 (3955-4075)	2000 (1960-2020)	4116	2043
4000	2125	4096	2198	3840	1945	4000 (3955-4075)	2125 (2085-2145)	4116	2168
4500	2000	4596	2073	4340	1820	4500 (4455-4575)	2000 (1960-2020)	4616	2043
4500	2125	4596	2198	4340	1945	4500 (4455-4575)	2125 (2085-2145)	4616	2168
4500	2250	4596	2323	4340	2070	4500 (4455-4575)	2250 (2210-2270)	4616	2293
5000	2000	5096	2073	4840	1820	5000 (4955-5075)	2000 (1960-2020)	5116	2043
5000	2125	5096	2198	4840	1945	5000 (4955-5075)	2125 (2085-2145)	5116	2168

#### Please note

- \* Clear passage dimensions (door with stepped floor)  
 \*\* Taking an additional 30 mm (with N80 door) and 40 mm (with DF98 door) bottom stop into consideration.

Width: ordering size minus 140 mm (160 mm for DF 98 door)  
 Height: ordering size minus 120 mm (180 mm for DF 98 door)  
 Height: ordering size minus 135 mm for design 905 (200 mm for DF 98 door)  
 Height: 30 mm more passage (with flat floor) (25 mm with DF98 door)



**Maximum size range (depending on door design) Dimensions in mm**

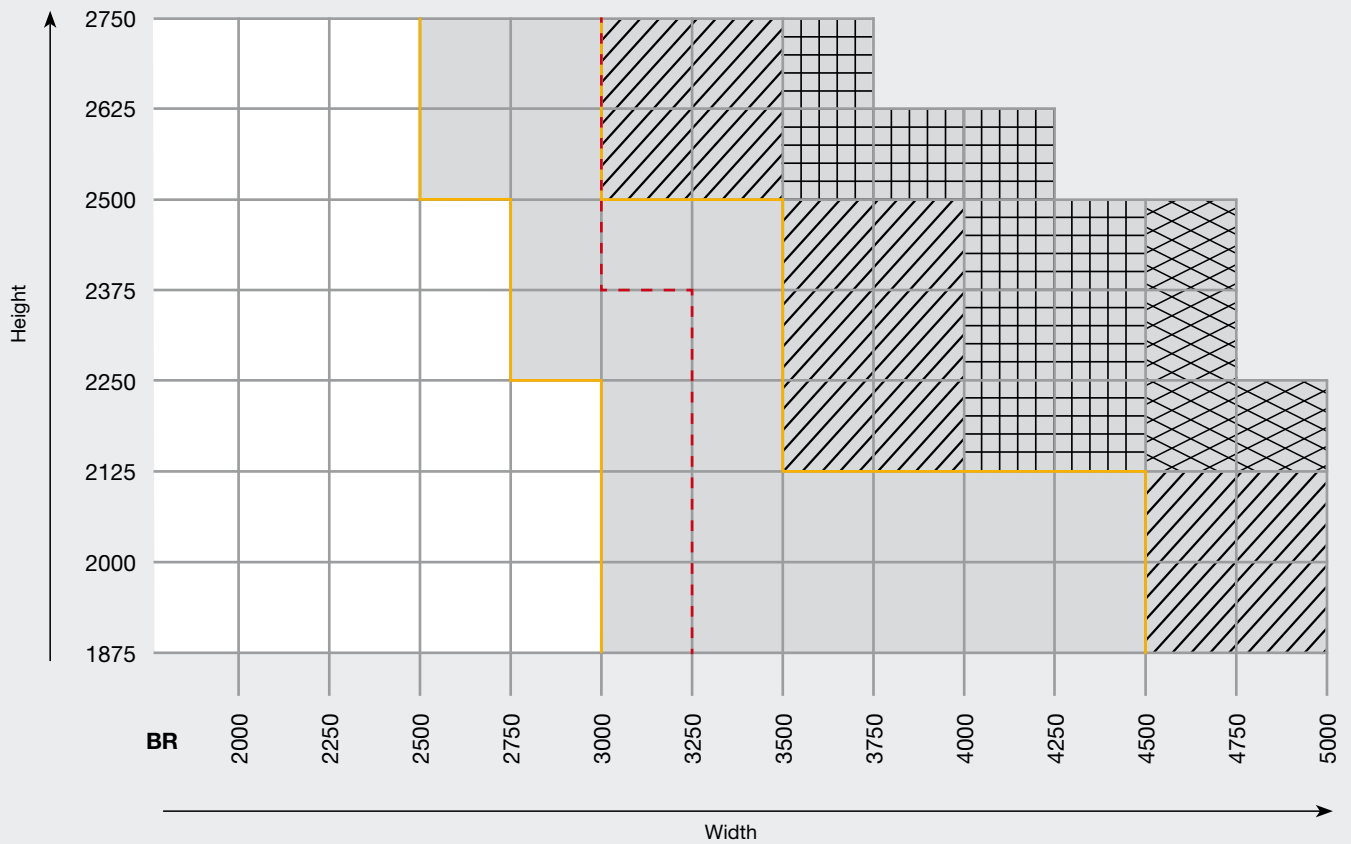

**Size range**

N 80 door type for single garages

N 80 door type Design 902

DF 98 door type for double garages

**DF 98 door type Design 905 Infill weight**

up to max. 14 kg/m<sup>2</sup>

up to max. bis 12 kg/m<sup>2</sup>

up to max. bis 10 kg/m<sup>2</sup>

**Open-for-infill doors (design 905)**

Please note the maximum weight for site infills, which, depending on the door size, ranges between 6 and 10 kg/m<sup>2</sup>. Depending on their size, DF 98 doors are also available with an infill weight of up to 16 kg/m<sup>2</sup> (exception: doors within the shaded area above). Consult your Hörmann specialist dealer who will be able to tell you the exact infill weight per m<sup>2</sup> for your particular door.

**Doors with renovation panel**

In the width the structural dimension may not be reduced by more than 10 mm. In the case of a stepped floor, the recommended structural height may not be reduced by more than 10 mm. For garage doors with a finished flat floor line (frame stands on FFL), 30 mm should be added to the recommended structural height.

# Up-and-Over Doors

## Door type N80 for single garages

### Fitting dimensions

#### Position of anchors

#### Dimensions in mm

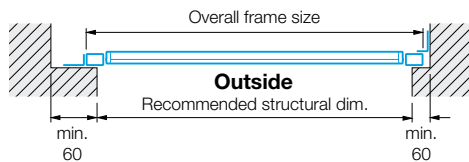
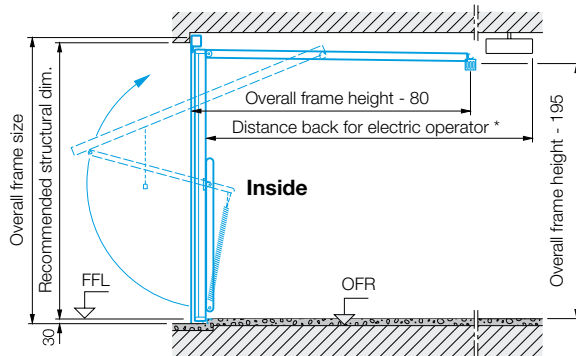
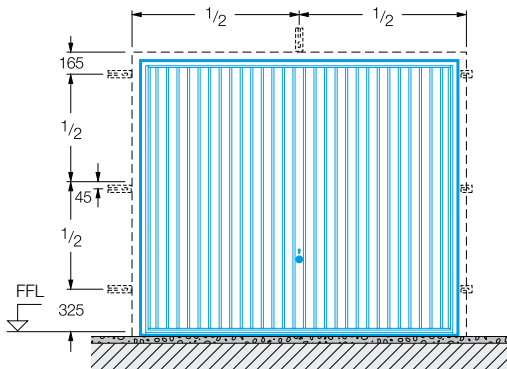

\* Distance back for electric operators:  
 3200 mm up to door height 2500 mm ProMatic/SupraMatic  
 3450 mm up to door height 2750 mm ProMatic/SupraMatic

#### Fitting behind the opening

#### Door with stepped floor

#### Door with flat floor

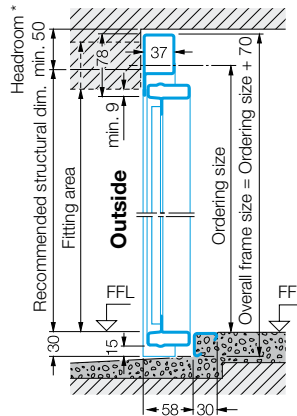
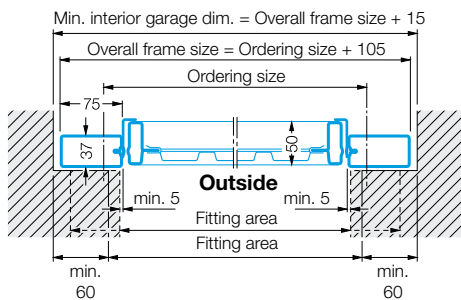

The structural height recommended in the table (page 32) must be increased by 30 mm.

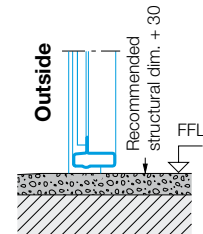

The recommended structural dimensions are recommended planning dimensions.

Minimum sideroom, headroom and opening sizes are all based on these dimensions.

#### With ProMatic/SupraMatic operator

\* No additional headroom required.

Exception: Designs 905, 941, designs with timber infill = 15 mm clearance.

#### Fitting in the opening

#### Door with stepped floor

#### Door with flat floor

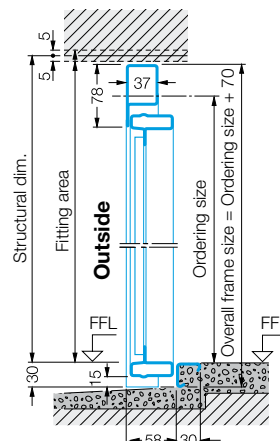
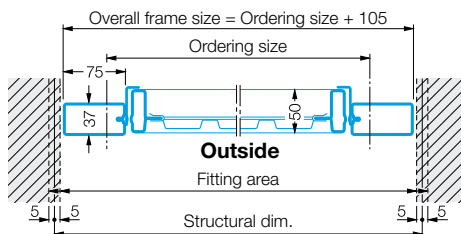

The structural height stated in the table (page 32) must be increased by 30 mm.

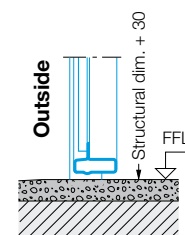

Fitting in the opening requires that the given dimensions be adhered to with greater accuracy, particularly where standard-sized doors are concerned. Special-sized doors are purpose-built for the existing structural opening.

#### With ProMatic/SupraMatic operator

No additional headroom required.

Exception: designs 905, 941, designs with timber infill = 15 mm clearance.

# Up-and-Over Doors

## Door type DF 98 for double garages

### Fitting details

**Position of anchors** **Dimensions in mm**

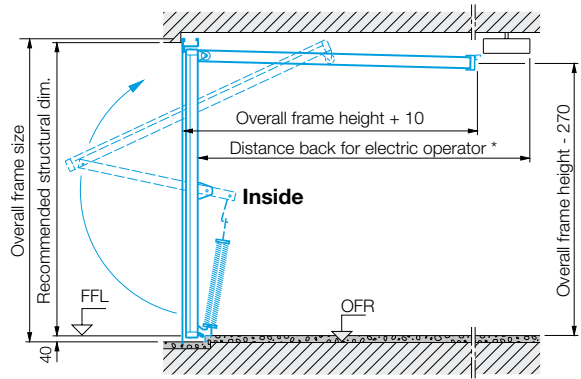
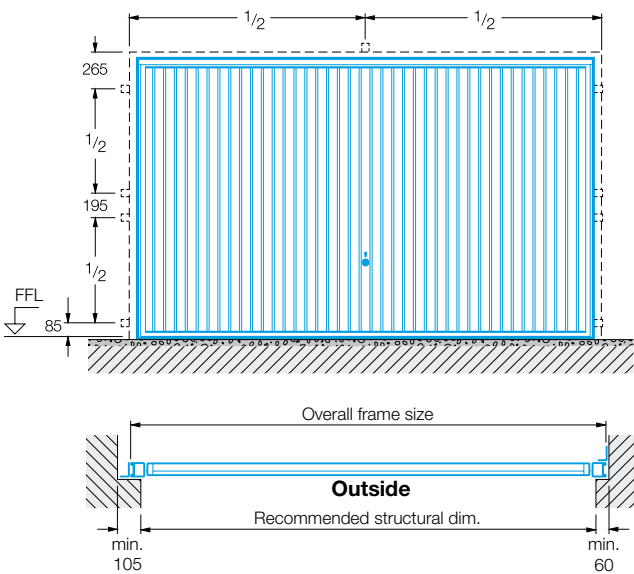

\* Distance back for electric operators:  
 3200 mm up to door height 2500 mm ProMatic/SupraMatic  
 3450 mm up to door height 2750 mm ProMatic/SupraMatic

**Fitting behind the opening** **Door with stepped floor** **Door with flat floor**

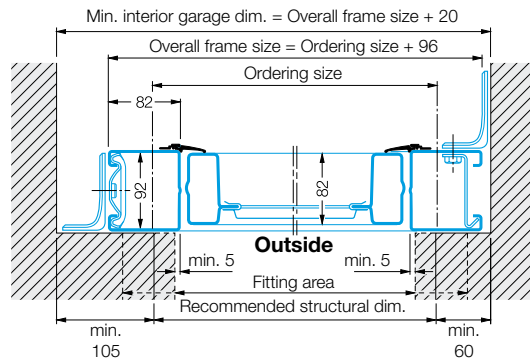

The recommended structural dimensions are recommended planning dimensions. Minimum sideroom, headroom and opening sizes are all based on these dimensions. Note for standard sizes: if the sideroom lies in the 60 mm to 105 mm range, this must be stated on the order.

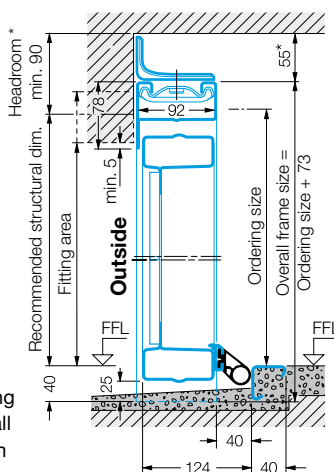

The structural height recommended in the table (page 32) must be increased by 25 mm.

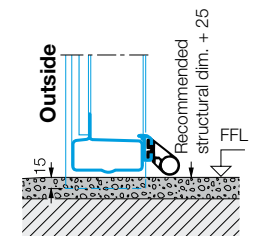

**With ProMatic/SupraMatic operator**  
 \* 65 mm clearance

**Fitting in the opening** **Door with stepped floor** **Door with flat floor**

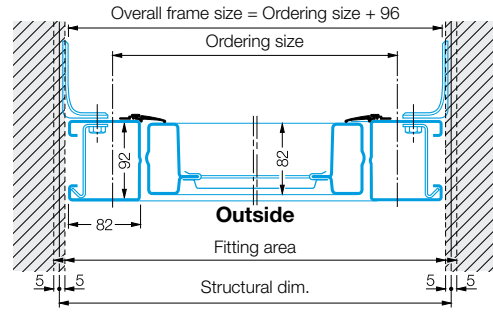

Fitting in the opening requires that the given dimensions be adhered to with greater accuracy, particularly where standard-sized doors are concerned. Special-sized doors are purpose-built for the existing structural opening.

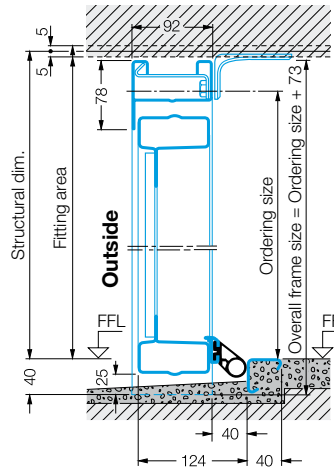

The structural height recommended in the table (page 32) must be increased by 25 mm.

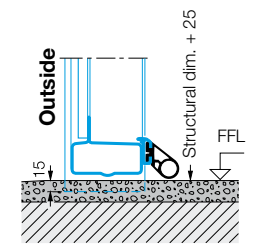

**With ProMatic/SupraMatic operator**  
 65 mm clearance

# Up-and-Over Doors

## Garage side doors

### Sizes and fitting dimensions

#### Single-leaf / Spacing of anchors Door with flat floor Door with stepped floor Dimensions in m

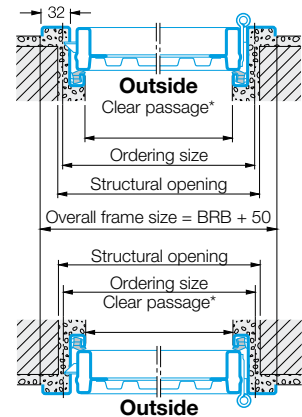
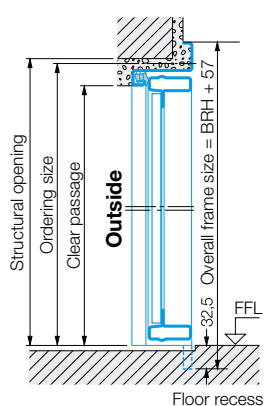
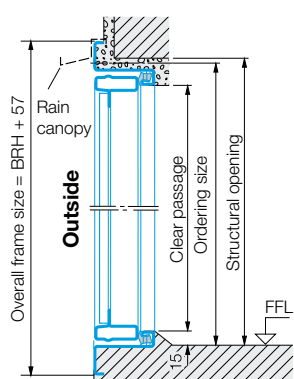
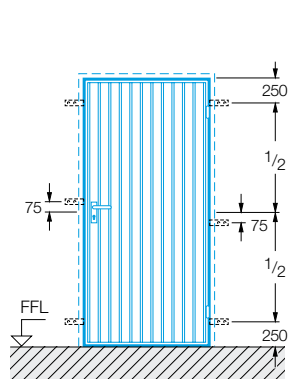

#### Standard sizes for single-leaf doors

Ordering size		Structural opening		Clear passage*		Handle Height from FFL
Width	Height	Width	Height	Width (BRB - 45)	Height (BRH - 38)	
875	1875	885	1880	830	1837	990
875	2000	885	2005	830	1962	1050
875	2125	885	2130	830	2087	1110
1000	2000	1010	2005	955	1962	1050
1000	2125	1010	2130	955	2087	1110

Designs 902 and 905 in standard sizes can be LH or RH hinged.

For doors with a stepped floor, opening outwards, the ordering height is always measured from the finished floor line of the deeper floor.

Standard sizes with steel infill and for site infill are supplied as standard for internal fitting (opening inwards). By reversing the fittings, the doors can be converted to external fitting (opening outwards). Designs with timber infill only possible for external fitting.

\* With an opening angle of less than 170°, the clear passage width is reduced.

Block frame for fitting into the opening: dimensions and versions on request.

Special sizes and special versions on request. Maximum size range (BR): 1250 x 2375 mm

#### Double-leaf / Spacing of anchors Door with flat floor Door with stepped floor

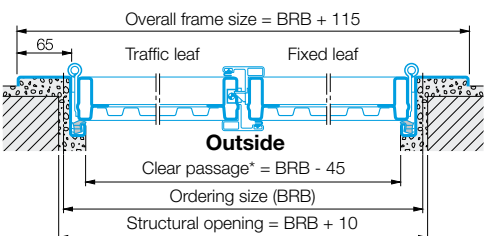
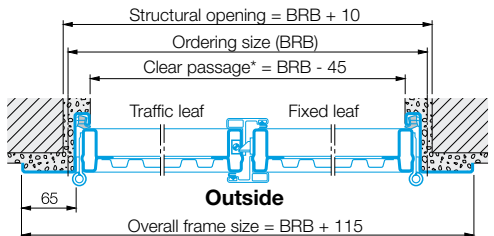
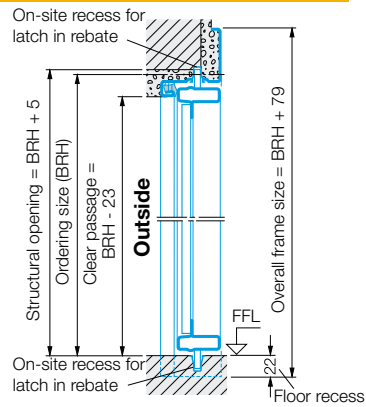
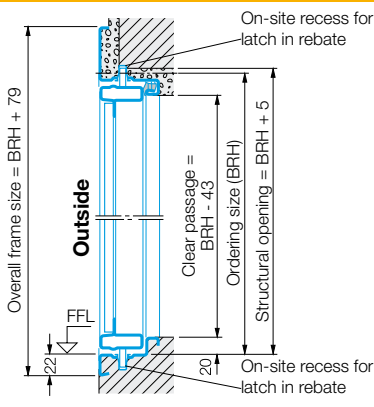
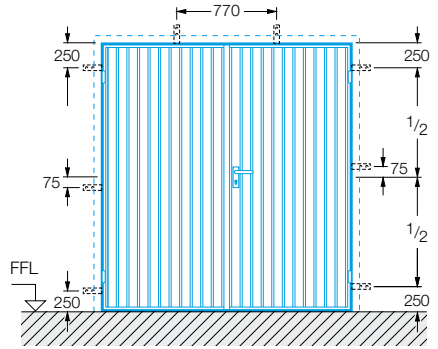

Block frame for fitting into the opening: dimensions and versions on request.

Supplied as standard for external fitting (opening outwards), traffic leaf on right.

If internal fitting (opening inwards) or traffic leaf on left required, state on order!

**Size range for double-leaf doors**  
 Width (ordering size): 1300 to 2500 mm  
 Height (ordering size): 1750 to 2250 mm  
 Panelled designs only up to ordering width = 2000 mm

\* With an opening angle of less than 170°, the clear passage width is reduced.

#### Fitting versions

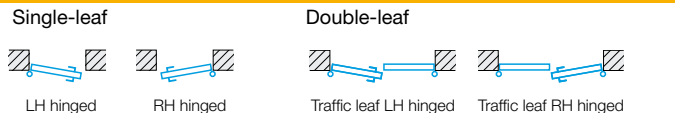
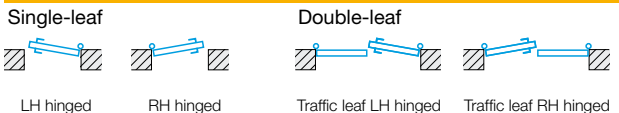

**External fitting**  
 With threshold profile.

**Internal fitting**  
 For internally fitted doors, the weather bar/transport angle should always be removed. Adequate water drainage to the outside must then be ensured. For doors on the weather side, external fitting is preferable.

# Up-and-Over Doors

## Door type F80 for ready-built garages

### Renovation sizes and fitting dimensions

Door sizes for concrete garages with an externally fitted door			Dimensions in mm	
Ordering size Width x height	Clear structural dimension* (fitting area) Width x height	Overall frame size	Clear passage Width x height	
2375 x 2045	2449 - 2489 x 2088 - 2108	2509 x 2148	2235 x 1925	
2375 x 2075	2449 - 2489 x 2118 - 2138	2509 x 2178	2235 x 1955	
2425 x 2075	2499 - 2539 x 2118 - 2138	2559 x 2178	2285 x 1955	
2485 x 2045	2559 - 2599 x 2088 - 2108	2619 x 2148	2345 x 1925	
2500 x 2075	2574 - 2614 x 2118 - 2138	2634 x 2178	2360 x 1955	
2500 x 2100	2574 - 2614 x 2143 - 2163	2634 x 2203	2360 x 1980	
2560 x 2125	2634 - 2674 x 2168 - 2188	2694 x 2228	2420 x 2005	
2570 x 2125	2644 - 2684 x 2168 - 2138	2704 x 2228	2430 x 2005	
2590 x 2075	2664 - 2704 x 2118 - 2138	2724 x 2178	2450 x 1955	
2590 x 2125	2664 - 2704 x 2168 - 2188	2724 x 2228	2450 x 2005	
2705 x 2125	2779 - 2819 x 2168 - 2188	2839 x 2228	2565 x 2005	
2715 x 2075	2789 - 2829 x 2118 - 2138	2849 x 2178	2575 x 1955	
2720 x 2200	2794 - 2834 x 2243 - 2263	2854 x 2303	2580 x 2080	
2730 x 2125	2804 - 2844 x 2168 - 2188	2864 x 2228	2590 x 2005	

  

Door sizes for standard-sized garages in the newly-formed German states			Dimensions in mm	
Ordering size Width x height	Clear structural dimension* (fitting area) Width x height	Overall frame size	Clear passage Width x height	
2325 x 1905	2399 - 2439 x 1948 - 1968	2459 x 2008	2185 x 1785	
2455 x 1905	2529 - 2569 x 1948 - 1968	2589 x 2008	2315 x 1785	
2350 x 1935	2424 - 2464 x 1978 - 1998	2484 x 2038	2210 x 1815	
2480 x 1935	2554 - 2594 x 1978 - 1998	2614 x 2038	2340 x 1815	

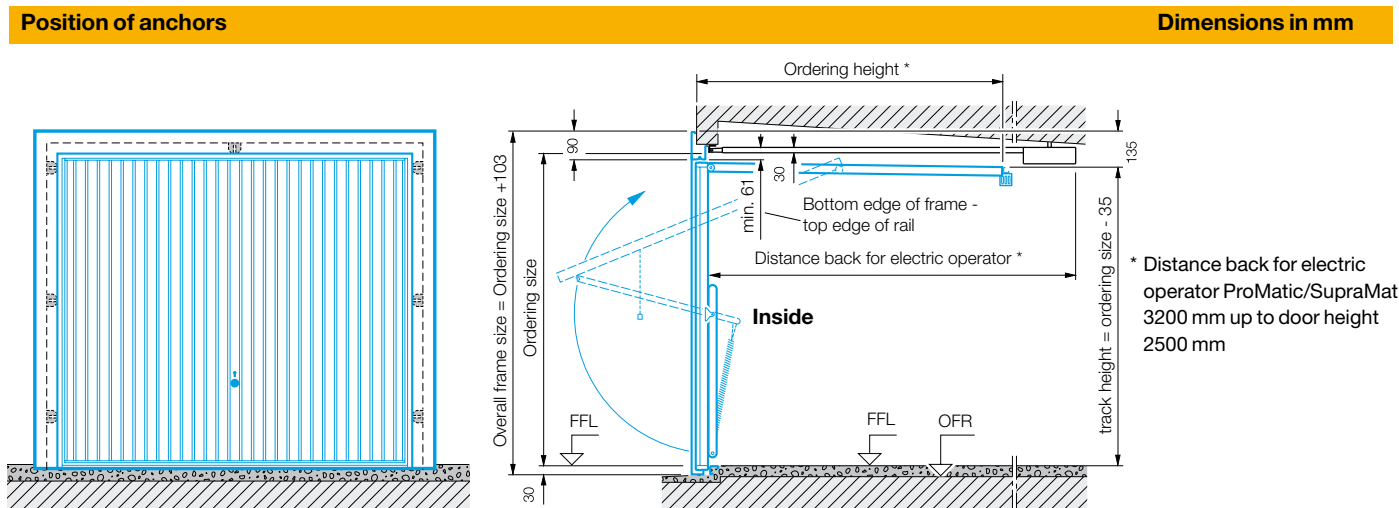

**Building structure with/without plaster framing** **with stepped floor** **with flat floor**

**Plug-and-screw fixing from 75 mm jamb depth**

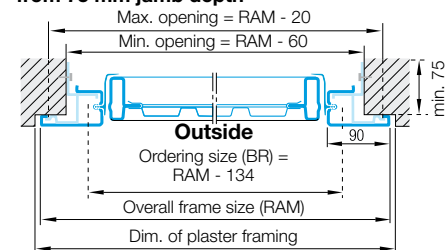

**Clamping at least 50 mm, max. 100 mm jamb depth**

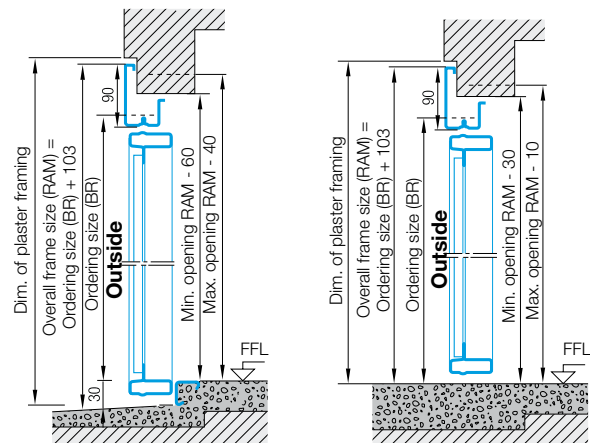
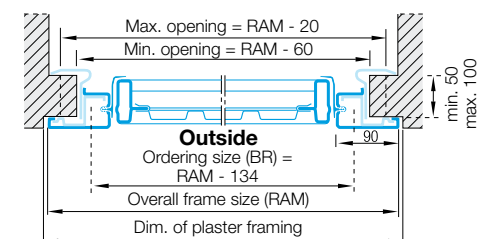

\* Taking into account an additional 30mm below threshold

Improved Aesthetics   Added Convenience   Increased Security

# Hörmann Quality Doors

To make the basement entrance secure, for wet rooms, the hobby room, a child's or teenager's bedroom, the converted loft, boiler room or as a door connecting the garage with the rest of the house.

The wide range means that a more economically-priced standard size will nearly always fit. Costly specials are not necessary. This saves you money!

Find out more about Hörmann's wide range of beautiful TopComfort entrance doors and canopies. Request our brochures or visit our website at [www.hoermann.com](http://www.hoermann.com).



## KS<sub>i</sub> security door

As a burglar-retarding steel door with multiple locking as standard. For the entrance to the basement, as a side door H8-5 or for the garage.

## MZ multi-purpose door

The sturdy steel door, also with insulating glazing. For basement rooms, outbuildings, equipment sheds, barns.

## H8-5 fire door

The officially approved fire-retardant steel door. Germany's best-selling boiler room door.



### Doors for All Areas of the Home



**H3-D multi-purpose door**  
 Fire-retardant and with the corresponding equipment, also smoke-tight, acoustic-rated and burglar-retardant. The ideal door for connecting the garage with the home.

**ZK internal door**  
 The decorative steel doors for all areas of the home, from the basement right up to the attic. In an array of colours, timber designs, glazings and equipment.

**Steel frame**  
 The slot-screw or welded standard frames that you can easily fit yourself, e.g. for the loft conversion.

